

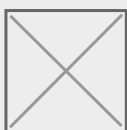

## Válvulas de esfera "Compact"

# Valvula sistema compact salida r/h FPM ITEM 718

REFERÊNCIA	DESCRIÇÃO	Peso líquido	Volume (m <sup>3</sup> )	Peso bruto	Unidades por lote
111C100	VALVULA COMPACT R/fêmea 1/2" FPM	0,106	0,00892	2,336	20
111C101	VALVULA COMPACT R/fêmea 3/4" FPM	0,13813	0,00892	2,95	20
111C102	VALVULA COMPACT R/fêmea 1" FPM	0,1976	0,01553	3,291	15
111C103	VALVULA COMPACT R/fêmea 1 1/4" FPM	0,337487	0,01553	5,389	15
111C104	VALVULA COMPACT R/fêmea 1 1/2" FPM	0,48533	0,01553	5,18	10
111C105	VALVULA COMPACT R/fêmea 2" FPM	0,8255	0,01553	4,454	5
111C106	VALVULA COMPACT R/fêmea 2 1/2" FPM	1,63	0,01553	3,832	2
111C107	VALVULA COMPACT R/fêmea 3" FPM	1,644	0,01553	3,712	2



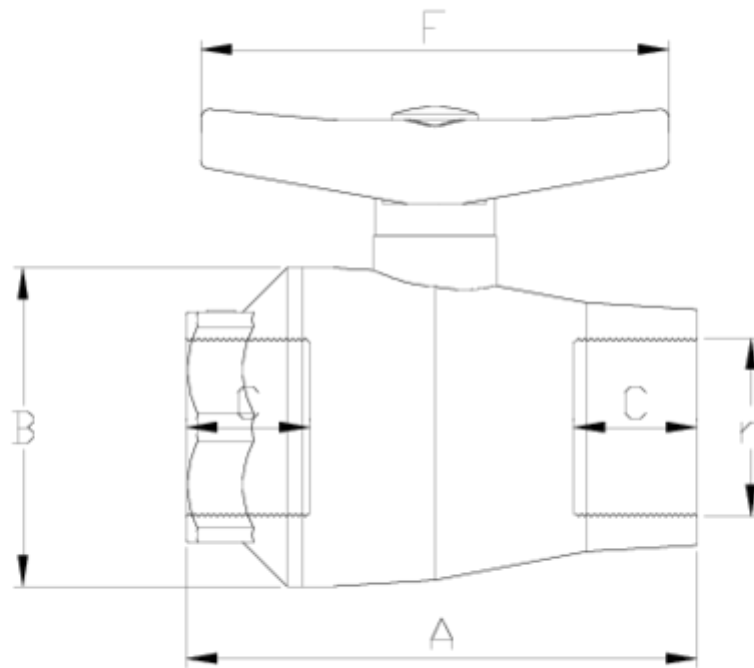

## ITEM 718 | Valvula sistema compact salida r/h FPM

CÓDIGO	r	DN	PESO (g)	A	B	C	F	PN	TIPO ROSCA
11C100	1/2"	15	106	82	48	17	80	PN10	BSP
11C101	3/4"	20	131	89	53	20	80	PN10	BSP
11C102	1"	25	197	101	59	23	101	PN10	BSP
11C103	1 1/4"	32	313	117	69	26	130	PN10	BSP
11C104	1 1/2"	40	459	141	83	33	130	PN10	BSP
11C105	2"	50	821	162	104	39	172	PN10	BSP
11C106	2 1/2"	65	1630	188	132	34	265	PN10	BSP
11C107	3"	65	1644	188	132	35	265	PN10	BSP

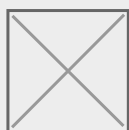



## Documentação do Produto

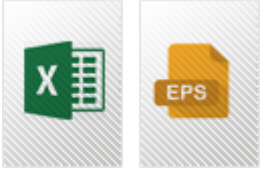

## Certificados do Produto

## Certificados da Empresa

