



## PVC-U pressure fittings

# Union, plain socket - female thread socket, female threaded outlet

## ITEM 030



REFERENCE	DESCRIPTION	Net weight	Volumen (m <sup>3</sup> )	Gross weight	Unidades lote
1002513	UNION, MALE THREAD.- FEMALE THREAD. 1"-1"	0,1141	0,00891	2,925	24
1002514	UNION, MALE THREAD.- FEMALE THREAD. 2"-2"	0,4295	0,03129	10,88	24
1002515	UNION, M. THREAD S./F. THREAD 1 1/2"-1 1/2"	0,2514	0,04717	15,725	60
1002519	UNION, M. THREAD S./F. THREAD 2"-1 1/2"	0,411	0,03129	10,437	24

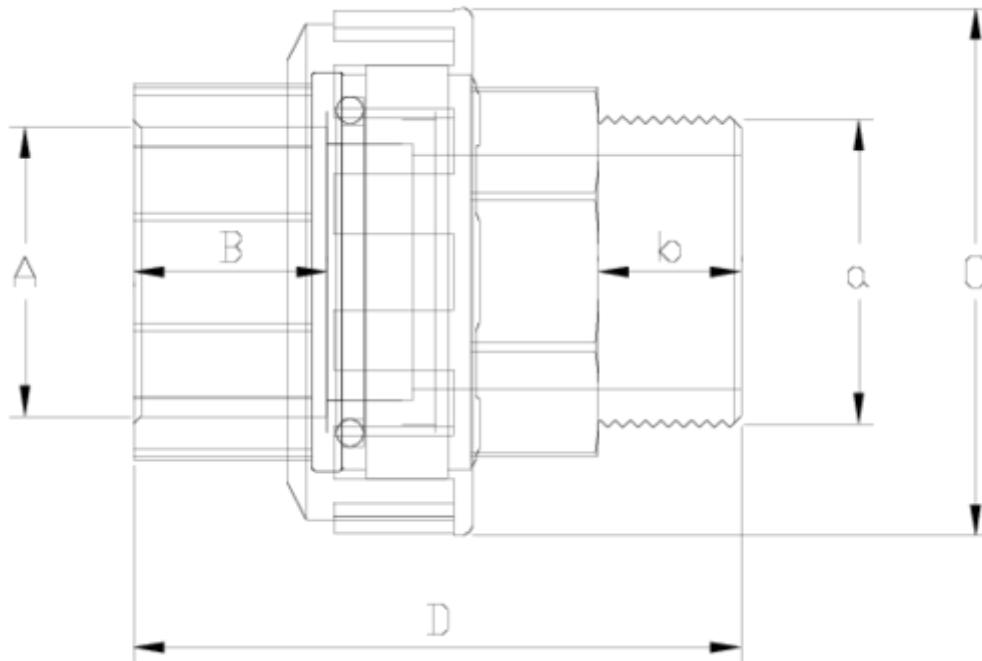

## ITEM 030 | Union, plain socket - female thread socket, female threaded outlet

Código	A-a	Peso (g)	B	b	C	D	PN	ROSCA
02515	1 1/2"-1 1/2"	201	31	34	80	85	PN10	BSP
02519	2"-1 1/2"	314	38	34	98	95	PN10	BSP



## Product Documents



## Product Certificates



## Company Certificates

