



## 'Semi compact' ball valves

# F. thread-solvent s. outlet

## ITEM 727

REFERENCE	DESCRIPTION	Net weight	Volumen (m <sup>3</sup> )	Gross weight	Unidades lote
111S015	SEMI-COMPACT BALL V. PLAIN-FEMALE TH 50	0,6705	0,03129	10,63	15
111S016	SEMI-COMPACT BALL V. PLAIN-FEMALE TH 63	1,065	0,03682	11,2	10
111S017	SEMI-COMPACT BALL V. PLAIN-FEMALE TH 75	2,01675	0,03129	8,64	4
111S018	SEMI-COMPACT BALL V. PLAIN-FEMALE TH 90	3,4235	0,02243	7,3347	2
111S019	SEMI-COMPACT BALL V. PLAIN-FEMALE TH 110	4,518	0,04460	9,866	2

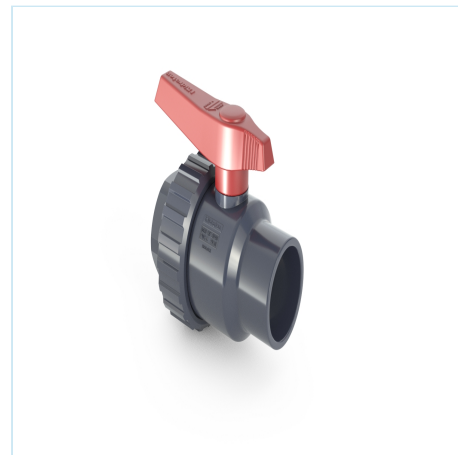

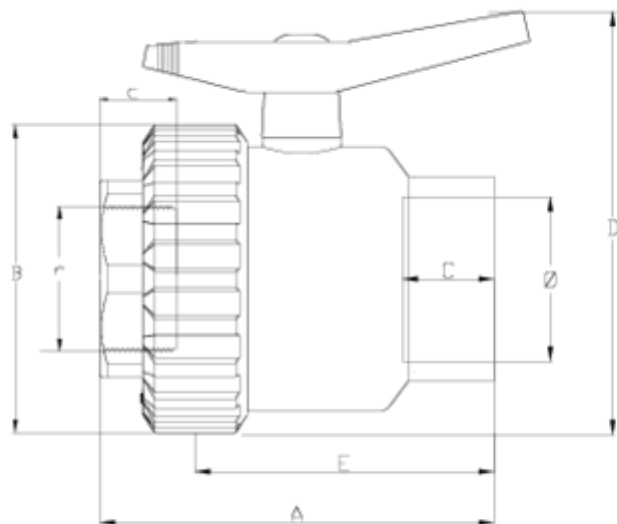

## ITEM 727 | F. thread-solvent s. outlet

CÓDIGO PE	f-r	DN	PESO (g)	A	B	C	c	D	E	PN	TIPO ROSCA
11S015	50-1 1/2"	40	644	147	99	31	33	138	109	PN10	BSP
11S016	63-2"	50	1025	167	116	38	29	172	124	PN10	BSP
11S017	75-2 1/2"	65	2054	204	150	45	33	215	165	PN10	BSP
11S018	90-3"	80	3111	223	178	51	36	251	180	PN10	BSP
11S019	110-4"	100	4602	255	210	61	42	307	206	PN10	BSP



## Product Documents



## Product Certificates

## Company Certificates

