



## PVC check valves (with spring)

# Reinforced female threaded outlet - Foot - EPDM seal ITEM 600



REFERENCE	DESCRIPTION	Net weight	Volumen (m <sup>3</sup> )	Gross weight	Unidades lote
1016350	PVC FOOT CHECK V. (W/S) FEM.TH.REINF.1/2"	0,132	0,01553	5,36	40
1016351	PVC FOOT CHECK V. (W/S) FEM.TH.REINF.3/4"	0,195	0,02244	6,98	40
1016352	PVC FOOT CHECK V. (W/S) FEM.TH.REINF.1"	0,302	0,02244	8,46	30
1016353	PVC FOOT CHECK V. (W/S) FEM.TH.REINF.1 1/4"	0,462	0,03129	9,56	20
1016354	PVC FOOT CHECK V. (W/S) FEM.TH.REINF.1 1/2"	0,682	0,02244	8,724	12
1016355	PVC FOOT CHECK V. (W/S) FEM.TH.REINF.2"	1,107	0,02244	13,44	12
1016356	PVC FOOT CHECK V. (W/S) FEM.TH.REINF.2 1/2"	2,13	0,03129	9,135	4
1016357	PVC FOOT CHECK V. (W/S) FEM.TH.REINF.3"	3,343	0,03129	8,17	2

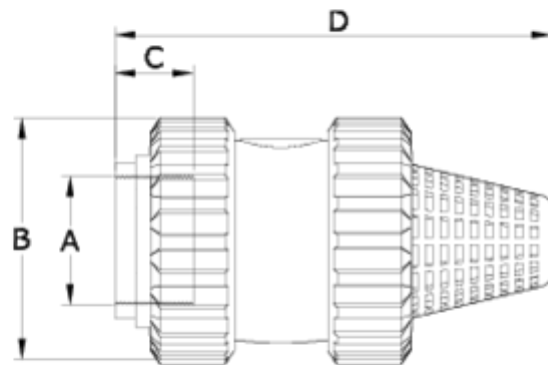

## ITEM 600 | Reinforced female threaded outlet - Foot - EPDM seal

Código EPDM	A	Peso	B	C	D	PN	TIPO ROSCA
16350	1/2"	137	52	16	106	PN16	BSP
16351	3/4"	175	59	17	118	PN16	BSP
16352	1"	285	69	21	147	PN16	BSP
16353	1 1/4"	462	85	23	164	PN16	BSP
16354	1 1/2"	700	99	31	175	PN16	BSP
16355	2"	1096	116	38	200	PN16	BSP
16356	2 1/2"	2425	150	44	260	PN10	BSP
16357	3"	4150	178	52	303	PN10	BSP



## Product Documents



## Product Certificates

## Company Certificates

