



## PVC check valves (with spring)

# Fitting outlet - FPM seal

## ITEM 271

REFERENCE	DESCRIPTION	Net weight	Volumen (m <sup>3</sup> )	Gross weight	Unidades lote
1016531	PVC CHECK V. (W/SPR), FITTING O.20-20 FPM	0,2	0,02244	8,54	40
1016532	PVC CHECK V. (W/SPR), FITTING O.25-25 FPM	0,3055	0,03682	12,02	40
1016533	PVC CHECK V. (W/SPR), FITTING O.32-32 FPM	0,49	0,03682	13,07	30
1016534	PVC CHECK V. (W/SPR), FITTING O.40-40 FPM	0,873	0,03682	11,58	16
1016535	PVC CHECK V. (W/SPR), FITTING O.50-50 FPM	1,1926	0,04880	15,91	15
1016536	PVC CHECK V. (W/SPR), FITTING O.63-63 FPM	2,225	0,04836	22,25	10
1016537	PVC CHECK V. (W/SPR), FITTING O.75-75 FPM	3,5027	0,04836	14,21	5
1016538	PVC CHECK V. (W/SPR), FITTING O.90-90 FPM	6,117275	0,03648	12,872	2



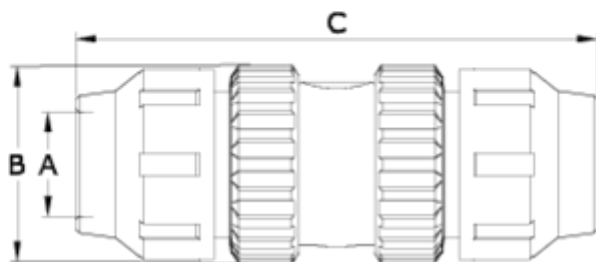

## ITEM 271 | Fitting outlet - FPM seal

Código Vitón	A	Peso	B	C	PN	MEDIDA
16531	20	200	52	170	PN16	MÉTRICO
16532	25	305	59	197	PN16	MÉTRICO
16533	32	480	69	239	PN16	MÉTRICO
16534	40	805	85	274	PN16	MÉTRICO
16535	50	1061	99	288	PN16	MÉTRICO
16536	63	1943	116	380	PN16	MÉTRICO
16537	75	4709	150	411	PN10	MÉTRICO
16538	90	7530	178	460	PN10	MÉTRICO



## Product Documents



## Product Certificates

## Company Certificates

