



## 'Compact' ball valves

# Male-female threaded elbow - FPM seal ITEM 888



| REFERENCE | DESCRIPTION                     | Net weight | Volumen (m <sup>3</sup> ) | Gross weight | Unidades lote |
|-----------|---------------------------------|------------|---------------------------|--------------|---------------|
| 111C190   | V.COMP.ACOD.RM-RH 1/2"-1/2" FPM | 0,129      | 0,00892                   | 2,787        | 20            |
| 111C191   | V.COMP.ACOD.RM-RH 1/2"-3/4" FPM | 0,128      | 0,00892                   | 2,771        | 20            |
| 111C192   | V.COMP.ACOD.RM-RH 3/4"-3/4" FPM | 0,1677     | 0,00892                   | 2,681        | 15            |
| 111C193   | V.COMP.ACOD.RM-RH 3/4"-1" FPM   | 0,166      | 0,00892                   | 2,655        | 15            |

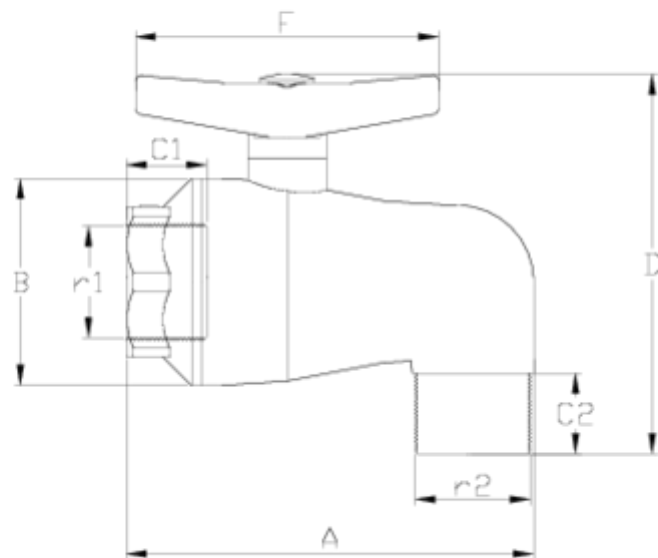

## ITEM 888 | Male-female threaded elbow - FPM seal

| CÓDIGO | r1-r2     | DN | PESO (g) | A   | B  | C1 | C2 | D   | F  | PN   | TIPO ROSCA |
|--------|-----------|----|----------|-----|----|----|----|-----|----|------|------------|
| 11C190 | 1/2"-1/2" | 15 | 129      | 98  | 48 | 14 | 14 | 104 | 80 | PN10 | BSP        |
| 11C191 | 1/2"-3/4" | 15 | 128      | 98  | 48 | 17 | 17 | 106 | 80 | PN10 | BSP        |
| 11C192 | 3/4"-3/4" | 20 | 168      | 105 | 53 | 21 | 17 | 109 | 80 | PN10 | BSP        |
| 11C193 | 3/4"-1"   | 20 | 166      | 105 | 53 | 21 | 21 | 112 | 80 | PN10 | BSP        |



## Product Documents



## Product Certificates

## Company Certificates

