



Flanges and adaptors

Plain flange union

ITEM 075

REFERENCE	DESCRIPTION	Net weight	Volumen (m ³)	Gross weight	Unidades lote
1010117	PVC PLAIN FLANGE SET 200-PN10	10,994	0,03682	11,555	1
1010147	PVC PLAIN FLANGE SET 50	1,47	0,00473	1,59	1
1010148	PVC PLAIN FLANGE SET 63	1,7461	0,00473	1,875	1
1010149	PVC PLAIN FLANGE SET 75	2,103	0,00473	2,22	1
1010150	PVC PLAIN FLANGE SET 90	3,4498	0,00892	3,649	1
1010151	PVC PLAIN FLANGE SET 110	4,2858	0,00892	4,485	1
1010152	PVC PLAIN FLANGE SET 125	4,5665	0,01553	4,905	1
1010153	PVC PLAIN FLANGE SET 140	5,5205	0,02244	6,02	1
1010154	PVC PLAIN FLANGE SET 160	8,2205	0,02244	8,72	1
1010155	PVC PLAIN FLANGE SET 200	9,5052	0,03129	10,09	1
1010156	PVC PLAIN FLANGE SET 225	10,8514	0,04717	11,505	1
1010157	PVC PLAIN FLANGE SET 250	16,2114	0,04717	16,865	1
1010158	PVC PLAIN FLANGE SET 315	23,02	0,13096	23,6	1



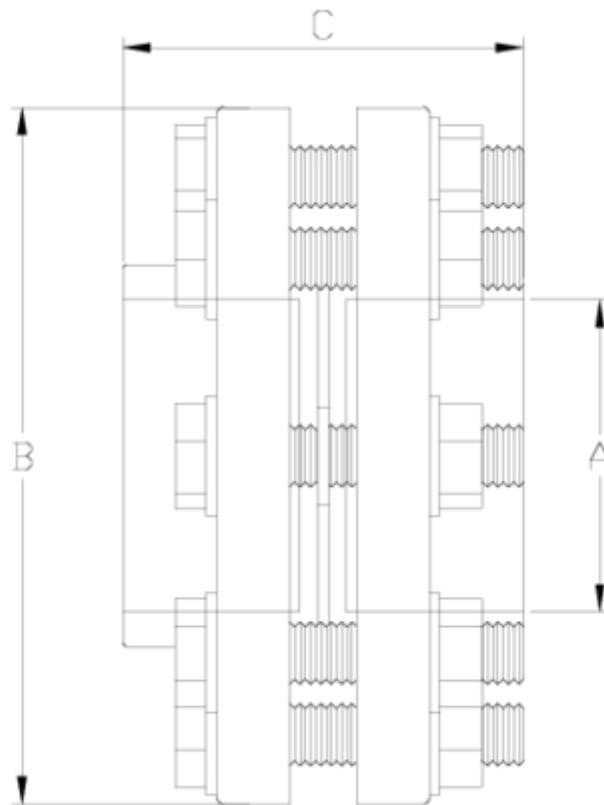

ITEM 075 | Plain flange union

Código	A	Peso (g)	B	C	PN	MEDIDA
10147	50	1395	150	71	PN16	MÉTRICO
10148	63	1726	165	87	PN16	MÉTRICO
10149	75	2046	185	97	PN16	MÉTRICO
10150	90	3287	200	115	PN16	MÉTRICO
10151	110	4104	220	136	PN16	MÉTRICO
10152	125	4455	230	152	PN16	MÉTRICO
10153	140	5214	250	166	PN16	MÉTRICO
10154	160	6298	285	186	PN10	MÉTRICO
10155	200	9769	315	229	PN6	MÉTRICO
10117	200-PN10	11841	340	242	PN10	MÉTRICO



ITEM 075 | Plain flange union

10156	225	10953	340	255	PN10	MÉTRICO
10157	250	14319	400	284	PN10	MÉTRICO
10158	315	21243	450	351	PN10	MÉTRICO



Product Documents

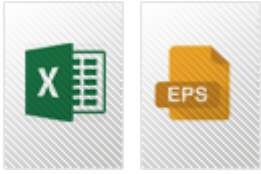

Product Certificates



Company Certificates

