



'Compact' ball valves

Female threaded - PTFE seal ITEM 566

| REFERENCE | DESCRIPTION | Net weight | Volumen (m ³) | Gross weight | Unidades lote |
|-----------|-------------------------------------|------------|---------------------------|--------------|---------------|
| 111C000 | GFPP COMP.B.V.1/2" F/THREADED END | 0,10863 | 0,00892 | 2,36 | 20 |
| 111C001 | GFPP COMP.B.V.3/4" F/THREADED END | 0,13138 | 0,00892 | 2,865 | 20 |
| 111C002 | GFPP COMP.B.V.1" F/THREADED END | 0,19672 | 0,01553 | 3,252 | 15 |
| 111C003 | GFPP COMP.B.V.1 1/4" F/THREADED END | 0,313153 | 0,02244 | 5,185 | 15 |
| 111C004 | GFPP COMP.B.V.1 1/2" F/THREADED END | 0,45883 | 0,01553 | 4,915 | 10 |
| 111C005 | GFPP COMP.B.V.2" F/THREADED END | 0,82066 | 0,01553 | 4,43 | 5 |
| 111C006 | GFPP COMP.B.V.2 1/2" F/THREADED END | 1.7506 | 0.01553 | 3.828 | 2 |
| 111C007 | GFPP COMP.B.V. 3" F/THREADED END | 1.6442 | 0.01553 | 3.615 | 2 |



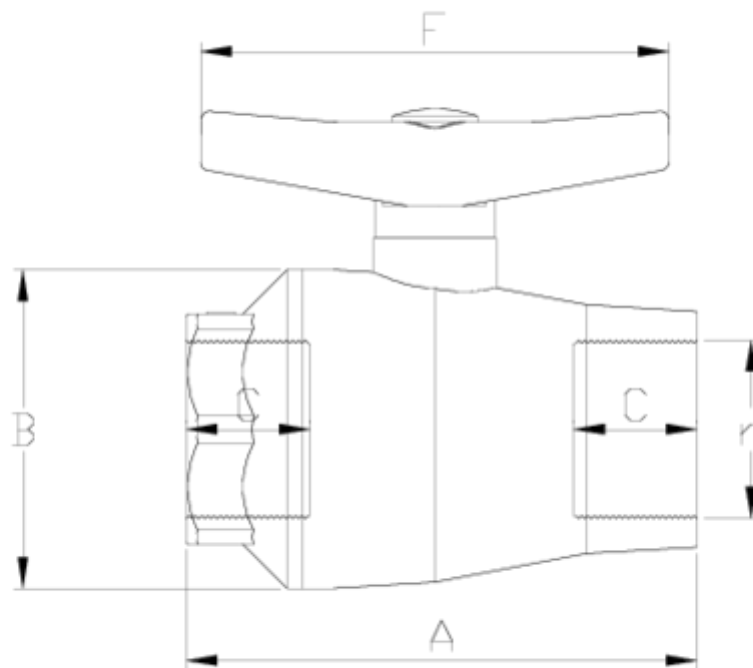

ITEM 566 | Female threaded - PTFE seal

| CÓDIGO | r | DN | PESO (g) | A | B | C | F | PN | TIPO ROSCA |
|--------|--------|----|----------|-----|-----|----|-----|------|------------|
| 11C000 | 1/2" | 15 | 106 | 82 | 48 | 17 | 80 | PN10 | BSP |
| 11C001 | 3/4" | 20 | 131 | 89 | 53 | 20 | 80 | PN10 | BSP |
| 11C002 | 1" | 25 | 197 | 101 | 59 | 23 | 101 | PN10 | BSP |
| 11C003 | 1 1/4" | 32 | 313 | 117 | 69 | 26 | 130 | PN10 | BSP |
| 11C004 | 1 1/2" | 40 | 459 | 141 | 83 | 33 | 130 | PN10 | BSP |
| 11C005 | 2" | 50 | 821 | 162 | 104 | 39 | 172 | PN10 | BSP |
| 11C006 | 2 1/2" | 65 | 1630 | 188 | 132 | 34 | 265 | PN10 | BSP |
| 11C007 | 3" | 65 | 1644 | 188 | 132 | 35 | 265 | PN10 | BSP |



Product Documents



Product Certificates

Company Certificates

