



## 'Compact' ball valves

# Elbow valve male threaded

# PTFE

## ITEM 885

| REFERENCE | DESCRIPTION                                  | Net weight | Volumen (m <sup>3</sup> ) | Gross weight | Unidades lote |
|-----------|--|------------|---------------------------|--------------|---------------|
| 111C080   | PPGF 90° ELBOW VALV. M/THR.-M/THR. 1/2"-1/2" | 0,13263    | 0,00892                   | 2,89         | 20            |
| 111C081   | PPGF 90° ELBOW VALV. M/THR.-M/THR. 1/2"-3/4" | 0,13138    | 0,00892                   | 2,865        | 20            |
| 111C082   | PPGF 90° ELBOW VALV. M/THR.-M/THR. 3/4"-3/4" | 0,177007   | 0,00892                   | 2,88         | 15            |
| 111C083   | PPGF 90° ELBOW VALV. M/THR.-M/THR. 3/4"-1"   | 0,1733     | 0,00892                   | 2,824        | 15            |



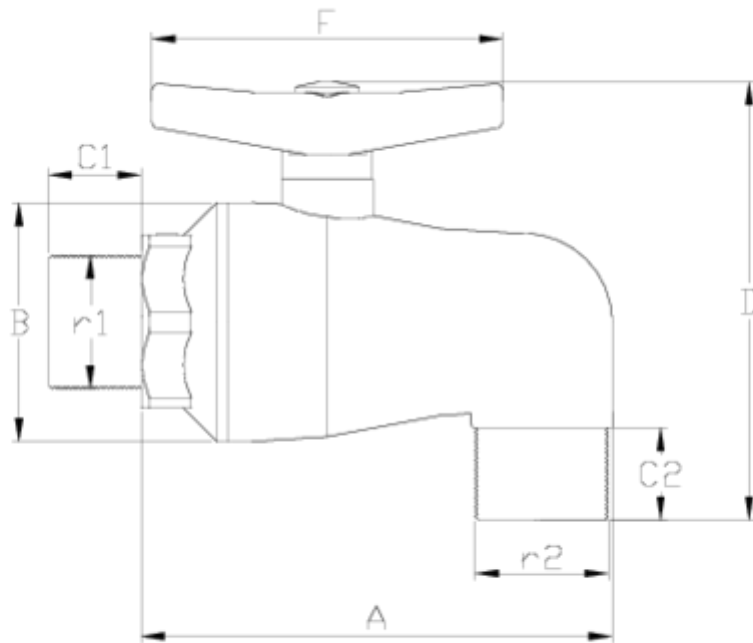

## ITEM 885 | Elbow valve male threaded PTFE

| CÓDIGO | r1-r2     | DN | PESO (g) | A   | B  | C1 | C2 | D   | F  | PN   | TIPO ROSCA |
|--------|-----------|----|----------|-----|----|----|----|-----|----|------|------------|
| 11C080 | 1/2"-1/2" | 15 | 136.9    | 111 | 48 | 14 | 14 | 104 | 80 | PN16 | BSP        |
| 11C081 | 1/2"-3/4" | 15 | 138      | 111 | 48 | 14 | 17 | 106 | 80 | PN16 | BSP        |
| 11C082 | 3/4"-3/4" | 20 | 182      | 120 | 53 | 17 | 17 | 109 | 80 | PN16 | BSP        |
| 11C083 | 3/4"-1"   | 20 | 179      | 120 | 53 | 17 | 19 | 112 | 80 | PN16 | BSP        |



## Product Documents



## Product Certificates

## Company Certificates

