



## 'Compact' ball valves

# Elbow valve male - female threaded PTFE

## ITEM 886



REFERENCE	DESCRIPTION	Net weight	Volumen (m <sup>3</sup> )	Gross weight	Unidades lote
111C090	PPGF 90° ELBOW VALV. M/THR.-F/THR. 1/2"-1/2"	0,129	0,00892	2,815	20
111C091	PPGF 90° ELBOW VALV. M/THR.-F/THR. 1/2"-3/4"	0,12838	0,00892	2,805	20
111C092	PPGF 90° ELBOW VALV. M/THR.-F/THR. 3/4"-3/4"	0,171507	0,00892	2,76	15
111C093	PPGF 90° ELBOW VALV. M/THR.-F/THR. 3/4"-1"	0,166	0,00892	2,655	15

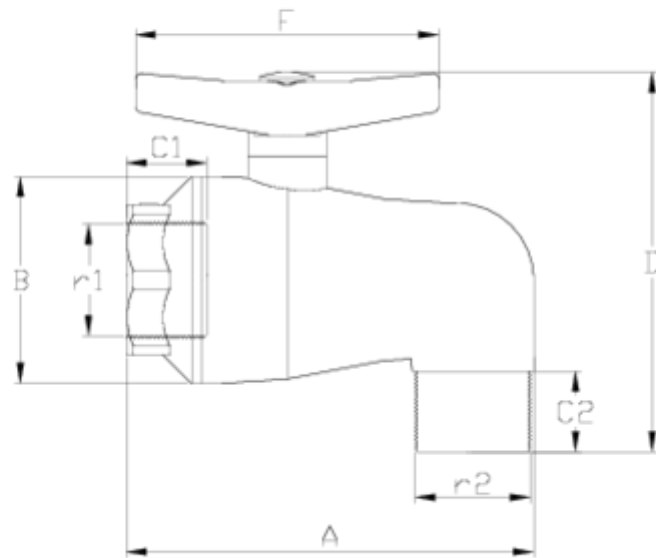

## ITEM 886 | Elbow valve male - female threaded PTFE

CÓDIGO	r1-r2	DN	PESO (g)	A	B	C1	C2	D	F	PN	TIPO ROSCA
11C090	1/2"-1/2"	15	128.88	98	48	14	14	104	80	PN10	BSP
11C091	1/2"-3/4"	15	128.38	98	48	17	17	106	80	PN10	BSP
11C092	3/4"-3/4"	20	168	105	53	21	17	109	80	PN10	BSP
11C093	3/4"-1"	20	166	105	53	21	21	112	80	PN10	BSP



## Product Documents



## Product Certificates

## Company Certificates

