



Brass pressure fittings

Straight coupling

ITEM 149

| REFERENCE | DESCRIPTION | Net weight | Volumen (m ³) | Gross weight | Unidades lote |
|-----------|-----------------------------|------------|---------------------------|--------------|---------------|
| 1020019 | BRASS STRAIGHT COUPLING 20 | 0,1199 | 0,00892 | 6,18 | 50 |
| 1020020 | BRASS STRAIGHT COUPLING 25 | 0,2014 | 0,00892 | 7,235 | 35 |
| 1020021 | BRASS STRAIGHT COUPLING 32 | 0,323726 | 0,01553 | 16,513 | 50 |
| 1020022 | BRASS STRAIGHT COUPLING 40 | 0,4844 | 0,01553 | 17,765 | 36 |
| 1020023 | BRASS STRAIGHT COUPLING 50 | 0,7586 | 0,01553 | 12,465 | 16 |
| 1020024 | BRASS STRAIGHT COUPLING 63 | 1,3463 | 0,01553 | 13,79 | 10 |
| 1020025 | BRASS STRAIGHT COUPLING 75 | 2,547217 | 0,01553 | 15,61 | 6 |
| 1020026 | BRASS STRAIGHT COUPLING 90 | 3,087 | 0,02244 | 19,062 | 6 |
| 1020027 | BRASS STRAIGHT COUPLING,110 | 5,6638 | 0,00892 | 11,515 | 2 |



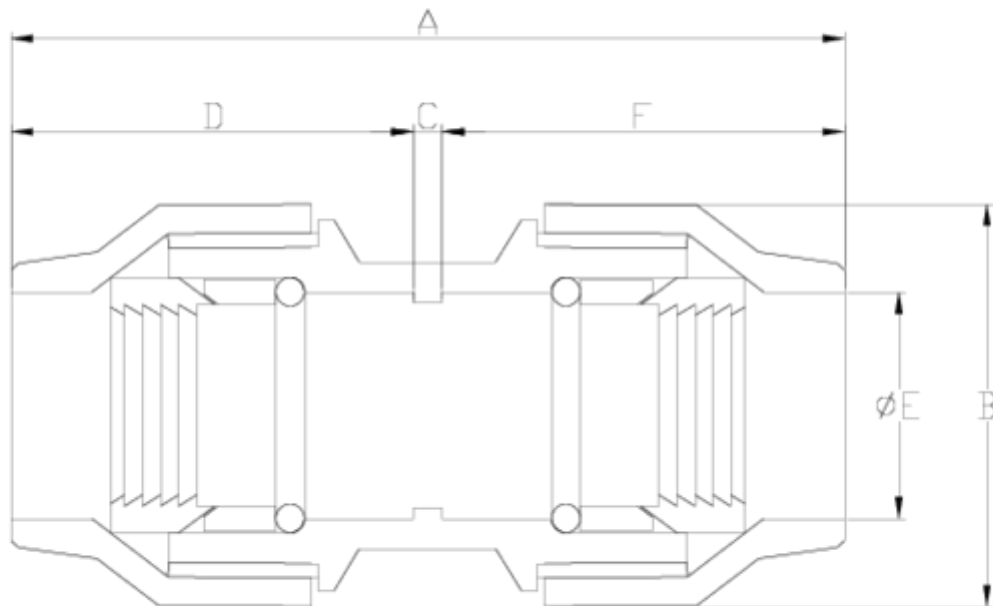

ITEM 149 | Straight coupling

| Código | f tubo | Peso (g) | A | B | C | D | E | F | PN | MEDIDA |
|--------|--------|----------|------|------|-------|------|------|------|------|---------|
| 20019 | 20 | 151 | 71 | 35 | 5.7 | 32.6 | 21 | 32.6 | PN25 | MÉTRICO |
| 20020 | 25 | 245 | 73.3 | 41.5 | 2.3 | 35.5 | 26 | 35.5 | PN25 | MÉTRICO |
| 20021 | 32 | 308 | 87.2 | 49.5 | 2.4 | 42.4 | 33 | 42.4 | PN25 | MÉTRICO |
| 20022 | 40 | 556 | 101 | 61 | 2 | 49.5 | 41.8 | 49.5 | PN25 | MÉTRICO |
| 20023 | 50 | 837 | 105 | 74.3 | 1.4 | 51.8 | 51.2 | 51.8 | PN25 | MÉTRICO |
| 20024 | 63 | 1350 | 135 | 91.2 | 4 | 65.5 | 64 | 65.5 | PN25 | MÉTRICO |
| 20025 | 75 | 2330 | 135 | 88 | 150.6 | | | | PN25 | MÉTRICO |
| 20026 | 90 | 3350 | 154 | 104 | 169.8 | | | | PN25 | MÉTRICO |
| 20027 | 110 | 4950 | 179 | 129 | 220 | | | | PN25 | MÉTRICO |



Product Documents



Product Certificates

Company Certificates

